

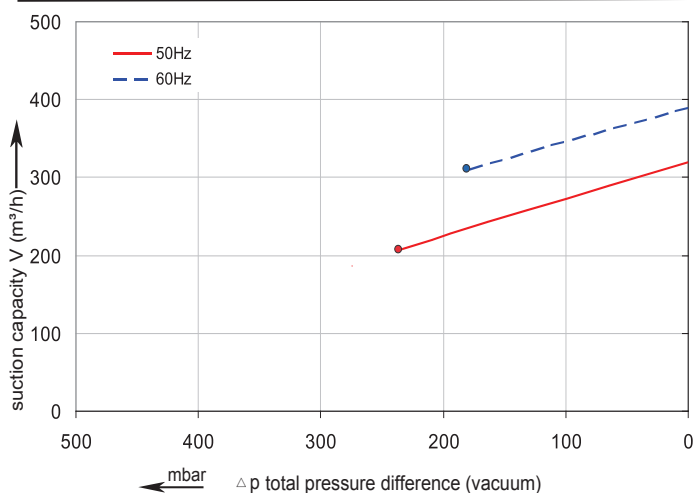

Single stage side channel
vacuum pump / compressor
EVSC-S71B3



Performance curve for Vacuum pump



Performance curve for Compressor

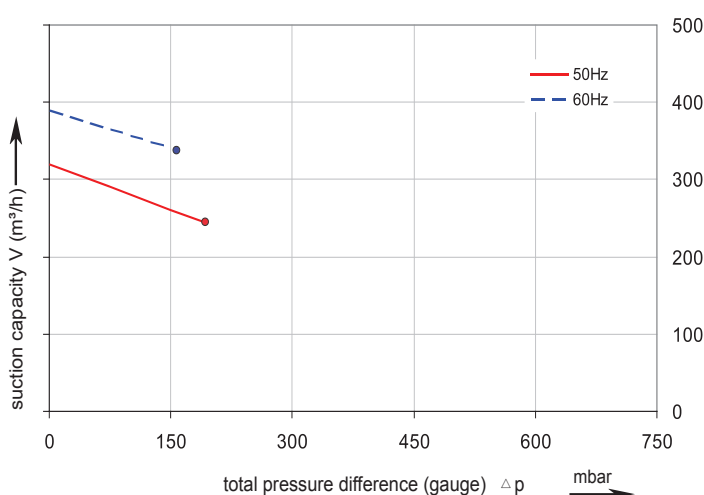

Technical Data TYPE EVSC-S71B3

		50 Hz	60 Hz
Motor power	kW	2,2	2,55
Maximum airflow	m³/h	318	376
Ultimate pressure	mbar	+170	+140
Ultimate vacuum	mbar	-180	-150
Input voltage 3 phase Δ	V	200-260	230-290
Input voltage 3 phase Y	V	350-450	400-500
Input current Δ	A	8,1	8,0
Input current Y	A	4,6	4,6
Noise level	dB(A)	69	72
Weight	kg	29	29
Connection inlet	G(BSP)	2"	2"
Connection outlet	G(BSP)	2"	2"

Ordering Information TYPE EVSC-S71B3

EVSC-S71B3	3ph AC	141371
Other voltages/frequencies		Upon request

Accessories

Vacuum/pressure relief valve	See page 123
Vacuum inline dust filter	140036
Compressor suction filter	140026
Set of feet for horizontal positioning	140012

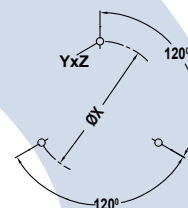
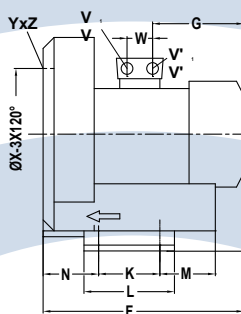
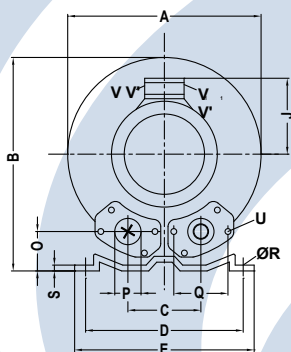

Type	Phases	A	B	C	D	E	F	G	H	J	K	L	M	N	O	P	Q	ØR	S	U	V	V	V ₁	V ₁	YxZ	X-Holes	ØX
EVSC-S71B3	3~	382	384	125	290	325	431	218	197	128	140	180	84	109	53	G2	83	15	4.5	M8X17	M25x1.5	M16x1.5	-	-	M10X20	0°/120°/240°	240