

Centering Ring without O-Ring

INFICON ISO-KF fittings are manufactured according to ISO 2861/1, DIN 28403 and Pneurop 6606. Our quality fittings are the standard components for all vacuum and high vacuum applications. The high quality INFICON components are designed and tested for leak rates less than 1×10^{-9} mbar l/s.



BENEFITS

- Competitively priced
- World wide logistics
- Design and measures follow strictly international respected standards
- 2011/65/EU RoHS compliant

ORDERING INFORMATION

Centering ring DN 10 ISO-KF, 316L	201-375
Centering ring DN 10 ISO-KF,Al	201-301
Centering ring DN 10 ISO-KF,Inox	201-308
Centering ring DN 16 ISO-KF, 316L	201-376
Centering ring DN 16 ISO-KF,Al	201-302
Centering ring DN 16 ISO-KF,Inox	201-309
Centering ring DN 20 ISO-KF, 316L	201-377
Centering ring DN 20 ISO-KF,Al	201-303
Centering ring DN 20 ISO-KF,Inox	201-310
Centering ring DN 25 ISO-KF, 316L	201-378
Centering ring DN 25 ISO-KF,Al	201-304
Centering ring DN 25 ISO-KF,Inox	201-311

Centering ring DN 32 ISO-KF, 316L	201-379
Centering ring DN 32 ISO-KF,Al	201-305
Centering ring DN 32 ISO-KF,Inox	201-312
Centering ring DN 40 ISO-KF, 316L	201-380
Centering ring DN 40 ISO-KF,Al	201-306
Centering ring DN 40 ISO-KF,Inox	201-313
Centering ring DN 50 ISO-KF, 316L	201-381
Centering ring DN 50 ISO-KF,Al	201-307
Centering ring DN 50 ISO-KF,Inox	201-314

SPECIFICATIONS

Type	.
DN 10 ISO-KF	
Dimension A	12
Dimension B	10
Dimension C	8
Ring:	Aluminum 6026/EN AW-6026 T6
DN 16 ISO-KF	
Dimension A	17
Dimension B	16
Dimension C	8
Ring:	Aluminum 6026/EN AW-6026 T6
DN 20 ISO-KF	
Dimension A	22
Dimension B	20
Dimension C	8
Ring:	Aluminum 6026/EN AW-6026 T6
DN 25 ISO-KF	
Dimension A	26
Dimension B	25
Dimension C	8
Ring:	Aluminum 6026/EN AW-6026 T6
DN 32 ISO-KF	
Dimension A	34
Dimension B	32
Dimension C	8

SPECIFICATIONS

Type

Ring:	Aluminum 6026/EN AW-6026 T6
<hr/>	
DN 40 ISO-KF	
Dimension A	41
Dimension B	40
Dimension C	8
Ring:	Aluminum 6026/EN AW-6026 T6
<hr/>	
DN 50 ISO-KF	
Dimension A	52
Dimension B	50
Dimension C	8
Ring:	Aluminum 6026/EN AW-6026 T6

DIMENSIONS

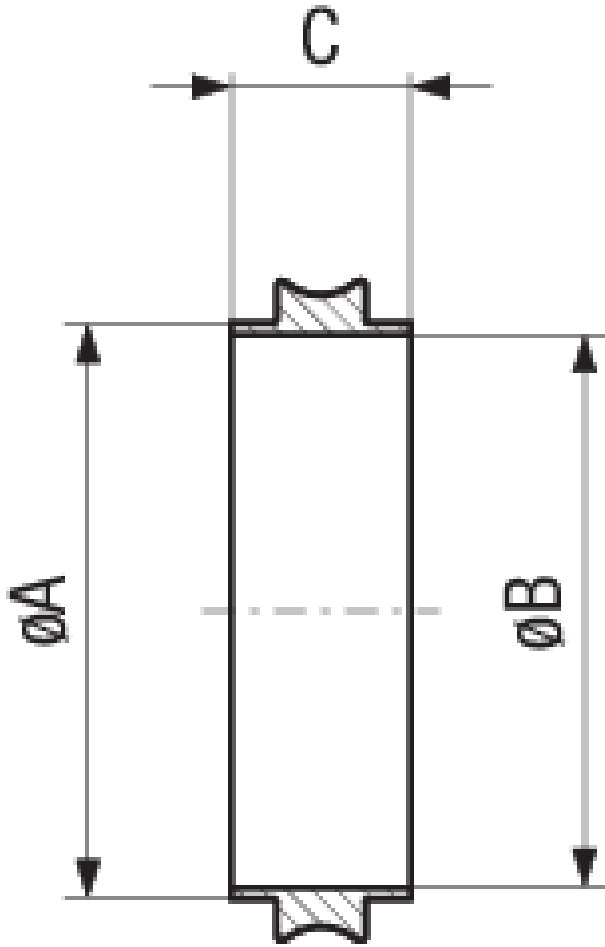

www.inficon.com reachus@inficon.com

Due to our continuing program of product improvements, specifications are subject to change without notice.
RateWatcher is a trademark of INFICON. All other trademarks are the property of their respective owners.

(2014-09) © 2014 INFICON