

Supportring for Aluminum Seal

INFICON ISO-KF fittings are manufactured according to ISO 2861/1, DIN 28403 and Pneurop 6606. Our quality fittings are the standard components for all vacuum and high vacuum applications. The high quality INFICON components are designed and tested for leak rates less than 1×10^{-9} mbar l/s.



BENEFITS

- Competitively priced
- World wide logistics
- Design and measures follow strictly international respected standards
- 2011/65/EU RoHS compliant

ORDERING INFORMATION

Type	DN 10-16 ISO-KF	DN 20-25 ISO-KF	DN 32-40 ISO-KF	DN 50 ISO-KF
Centering ring, inox, DN 10-16 KF, 32x7	211-171			
Centering ring, inox, DN 20-25 KF, 42x7		211-172		
Centering ring, inox, DN 32-40 KF, 57x7			211-173	
Centering ring, inox, DN 50 KF, 77x7				211-174

SPECIFICATIONS

Type	DN 10-16 ISO-KF	DN 20-25 ISO-KF	DN 32-40 ISO-KF	DN 50 ISO-KF
Dimension A	32	42	57	77
Dimension B	7	7	7	7
Material:	Stainless steel: 301 / 1.4310	Stainless steel: 301 / 1.4310	Stainless steel: 301 / 1.4310	Stainless steel: 301 / 1.4310
For Aluminum Seal (optional)	211-167	211-168	211-169	211-170

DIMENSIONS

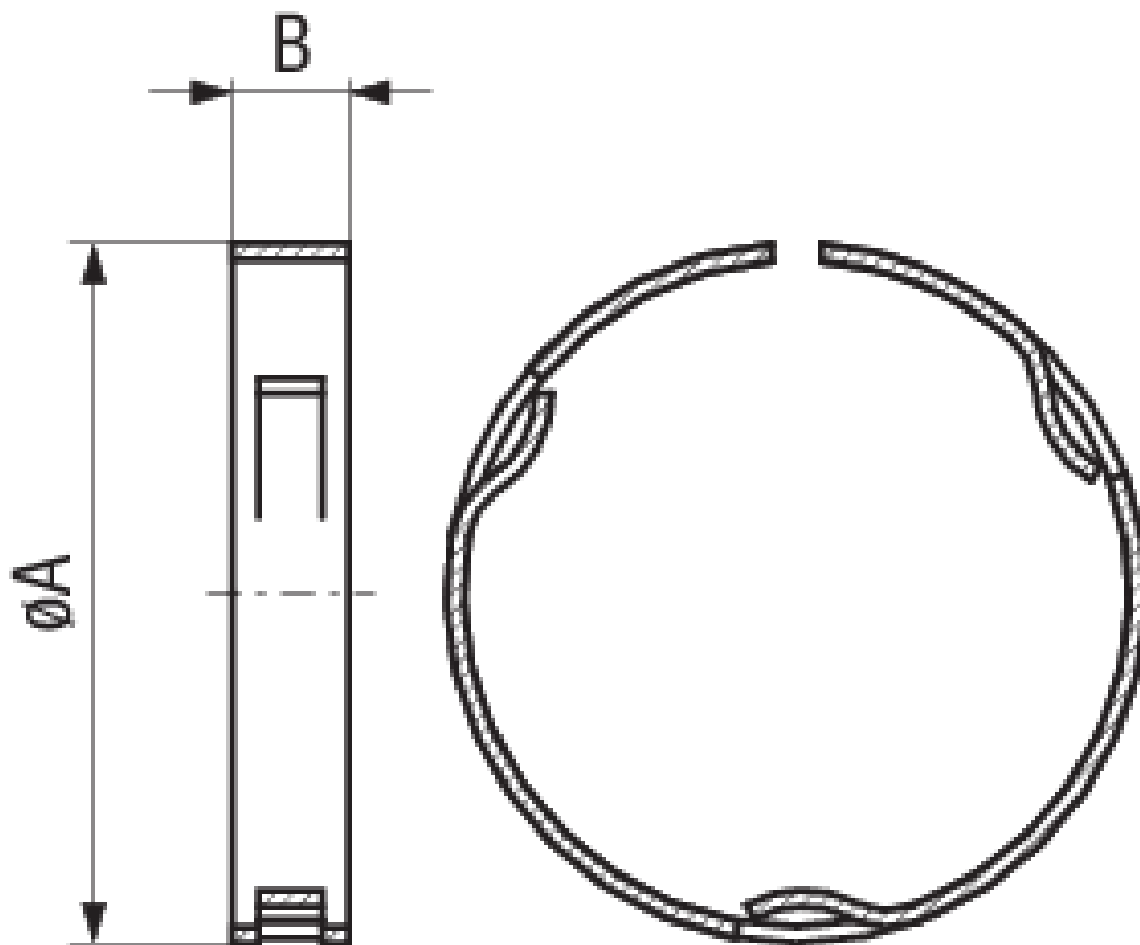

www.inficon.com reachus@inficon.com

Due to our continuing program of product improvements, specifications are subject to change without notice.
RateWatcher is a trademark of INFICON. All other trademarks are the property of their respective owners.

(2014-09) © 2014 INFICON