

# Sleeve with Hose Clamp

INFICON ISO-KF fittings are manufactured according to ISO 2861/1, DIN 28403 and Pneurop 6606. Our quality fittings are the standard components for all vacuum and high vacuum applications. The high quality INFICON components are designed and tested for leak rates less than  $1 \times 10^{-9}$  mbar l/s.



## BENEFITS

- Competitively priced
- World wide logistics
- Design and measures follow strictly international respected standards
- Surface finish, welds, material specifications and cleanliness meet or exceed high vacuum specifications
- 2011/65/EU RoHS compliant

## ORDERING INFORMATION

Type	DN 16 ISO-KF	DN 25 ISO-KF	DN 40 ISO-KF
Sleeve cpl., inox, CR, DN 16	211-417		
Sleeve cpl., inox, CR, DN 25		211-418	
Sleeve cpl., inox, CR, DN 40			211-419

## SPECIFICATIONS

Type	DN 16 ISO-KF	DN 25 ISO-KF	DN 40 ISO-KF
Dimension A	58	60	64
Dimension B	7	9	13
Dimension C	14	16	20
Dimension D	16	25	40
Dimension E	44	50	68
Sleeve:	CR	CR	CR
Hose clamp:	Stainless steel 430/-	Stainless steel 430/-	Stainless steel 430/-
Internal pressure:	Max. 1 bar	Max. 1 bar	Max. 1 bar

## DIMENSIONS

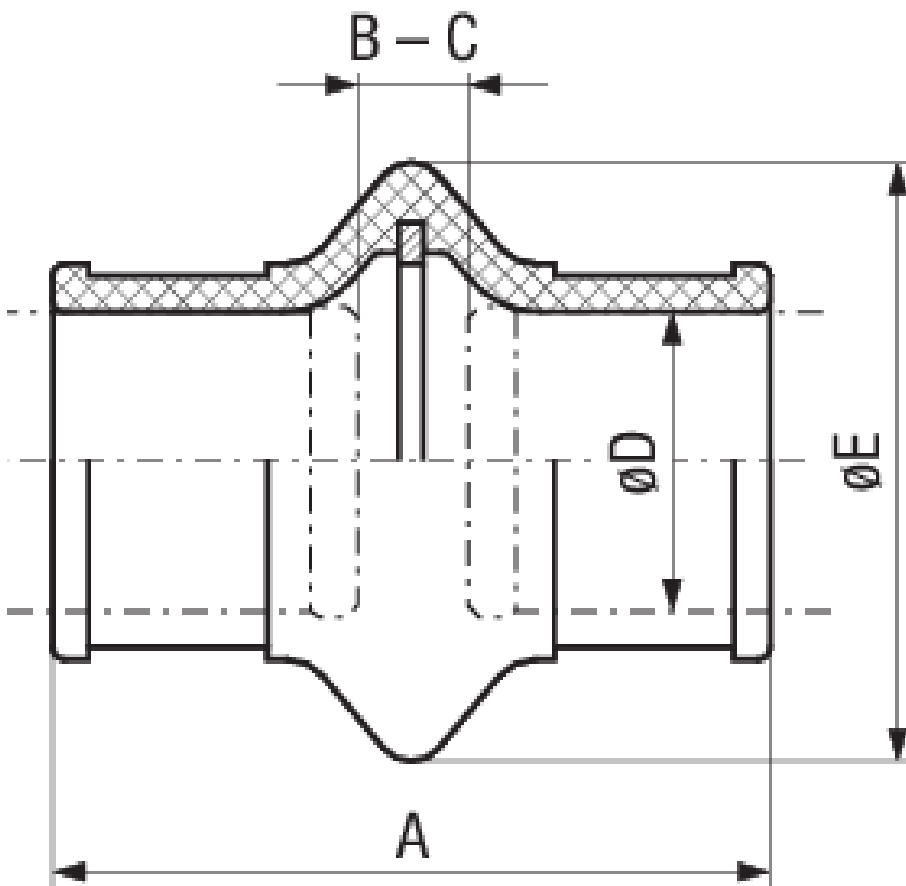

[www.inficon.com](http://www.inficon.com) [reachus@inficon.com](mailto:reachus@inficon.com)

Due to our continuing program of product improvements, specifications are subject to change without notice. RateWatcher is a trademark of INFICON. All other trademarks are the property of their respective owners.

(2014-09) © 2014 INFICON