

TYPE EVT-080E

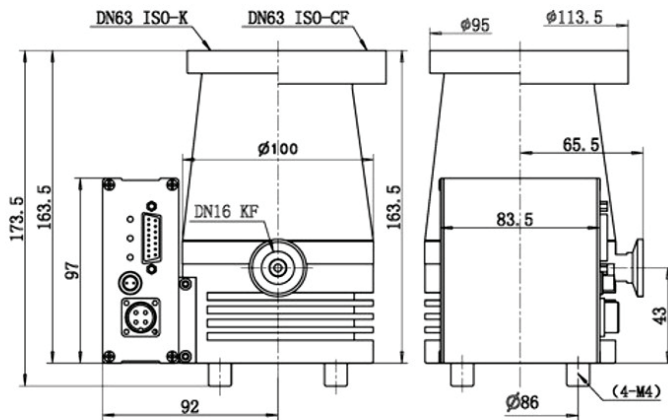
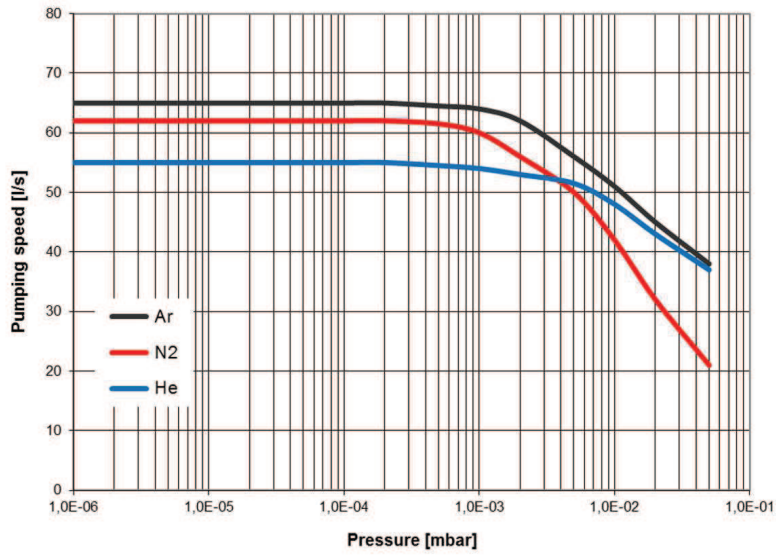

TYPE EVT-080E

Technical Data		TYPE EVT-080E	
		080E-LF	080E-CF
Pump type		Compound/Drag	Compound/Drag
Inlet Flange		63 ISO-K	63 CF
Fore vacuum Flange		16 KF	16 KF
Pumping speed (Ar)	l/s	65	65
Pumping speed (N ₂)	l/s	62	62
Pumping speed (He)	l/s	55	55
Fore vacuum max.	mbar	15	12
Rotation Speed	rpm	72.000	72.000
H ₂ Compression Ratio		> 2x10 ⁵	> 2x10 ⁵
N ₂ Compression Ratio		> 1x10 ⁹	> 1x10 ⁹
Ultimate Vacuum	mbar	< 3,5x10 ⁻⁸	< 5x10 ⁻⁹
Gas throughput at full speed	sccm	35	30
Run up Time	min	< 2	< 2
Control Unit		TC100 / TCP100	TC100 / TCP100
Input Voltage		24VDC / 100W	24VDC / 100W
Cooling medium		Air (water option)	Air (water option)
Max. magnetic field	mT	< 3	< 3
Bearing type		Ceramic Grease	Ceramic Grease
Operating Orientation		Any	Any
Weight Pump/Controller	kg	2,6 / 1,0	3,5 / 1,0
Communication modul		RS-232 (RS-485)	RS-232 (RS-485)
Controller dimensions l x w x h	mm	135x130x70	135x130x70

Ordering Information	TYPE EVT-080E	
	080E-LF	080E-CF
Turbo drag pump EVT-080E excl. control unit & cable	800802	800803
TC-100 onboard controller	800042	
TCP-100 controller and power supply	800041	
Controller cable 2,5 m	801011	
Controller cable 5 m	801012	
Recommended pre-vacuum pump: Standard operation Type EVD-VRD-2, 230V AC	417100	
Purge gas operation Type EVD-6, 230V AC	420901	