

# Sleeve with Hose Clamp

---

INFICON ISO-K quality fittings are manufactured according to ISO 1609, DIN 28404 and Pneurop 6606. Our quality large diameter fittings are the standard vacuum components for all vacuum and high vacuum lines. The high quality INFICON fittings are designed and tested for leak rates less than  $1 \times 10^{-9}$  mbar l/s.



## BENEFITS

---

- Competitively priced
- World wide logistics
- 2011/65/EU RoHS compliant

## ORDER INFORMATION

---

Type	DN 63 ISO-K	DN 100 ISO-K	DN 160 ISO-K
Sleeve cpl., CR, inox, DN 100 ISO-K		212-187	
Sleeve cpl., CR, inox, DN 160 ISO-K.			212-188
Sleeve cpl., CR, inox, DN 63 ISO-K	212-186		

## SPECIFICATIONS

Type	DN 63 ISO-K	DN 100 ISO-K	DN 160 ISO-K
Dimension A	70	72	72
Dimension B	14	8	8
Dimension C	24	26	26
Dimension D	75	106	155
Dimension E	120	150	200
Sleeve:	CR	CR	CR
Hose clamp:	Stainless steel	Stainless steel	Stainless steel
Tightening torque max.	4 Nm	4 Nm	4 Nm
Internal pressure:	Max. 1 bar	Max. 1 bar	Max. 1 bar

## DIMENSIONS

---

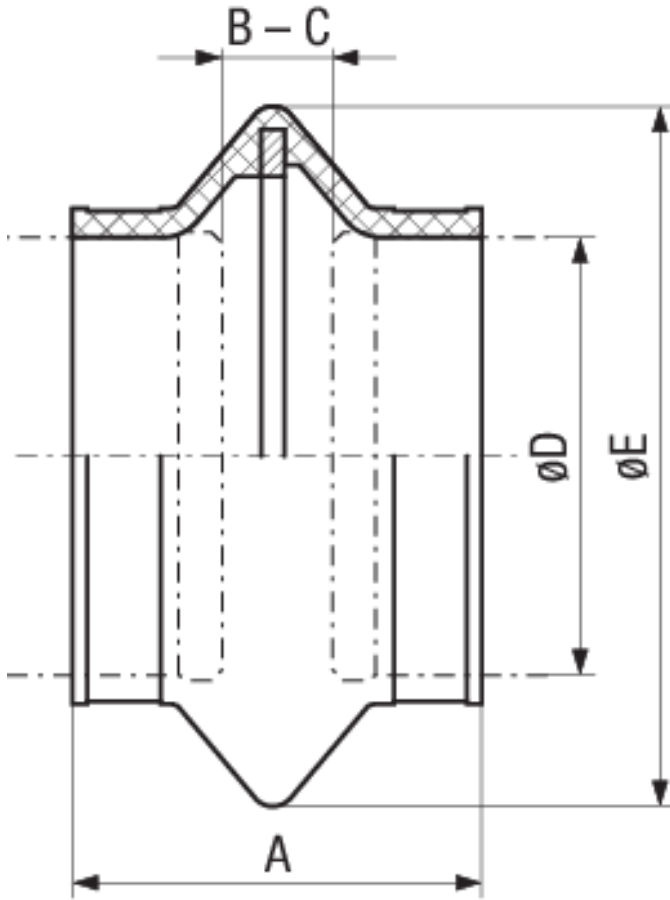

[www.inficon.com](http://www.inficon.com)    [reachus@inficon.com](mailto:reachus@inficon.com)

Due to our continuing program of product improvements, specifications are subject to change without notice.  
RateWatcher is a trademark of INFICON. All other trademarks are the property of their respective owners.

(2016-07)    © 2016 INFICON