

Intermediate Piece Insulated

INFICON CF quality fittings are manufactured according to ISO 3669 and the latest TS/ ISO 3669-2 standard. INFICON Ultra high vacuum fittings are designed for applications down to 1×10^{-12} mbar and bakeout temperatures up to 400°C.

BENEFITS

- World wide logistics
- Design and measures follow strictly international respected standards
- Surface finish, welds, material specifications and cleanliness meet or exceed high specifications
- 2011/65/EU RoHS compliant



ORDERING INFORMATION

Type	DN 40 CF	DN 63 CF
Insulated intermediate piece	213-212	213-213

SPECIFICATIONS

Type	DN 40 CF	DN 63 CF
Dimension A	70	90
Dimension B	1	1
Dimension C	1	1
Dimension D	25	53
Dimension E	30	45
Dimension F	34.5	66
Dimension G	44	65
Flanges:	Stainless steel 304L / 1.4306	Stainless steel 304L / 1.4306
Insulator:	Ceramic Al ₂ O ₃	Ceramic Al ₂ O ₃
Transition insulator/flange:	FeNi	FeNi
Bakeout temperature:	350° C	350° C
G=	Surface leakage 20 kV at 10-4 mbar	Surface leakage 20 kV at 10-4 mbar

DIMENSIONS

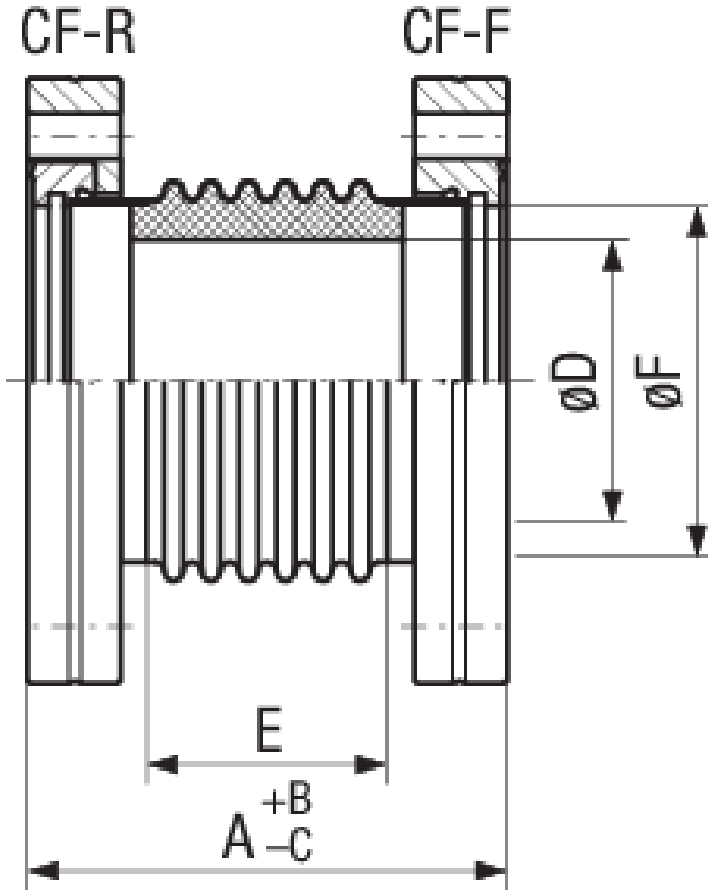

www.inficon.com reachus@inficon.com

Due to our continuing program of product improvements, specifications are subject to change without notice.
RateWatcher is a trademark of INFICON. All other trademarks are the property of their respective owners.

(2014-09) © 2014 INFICON