

# SPARE PARTS LIST

EV-0016L & NM



**Eurovacuum**

From serial number: 0601XXXX

---

## EV-0016L & NM

Rotary Vane Pumps

---

# ASS'Y Drawing EV-0010, 0016 & 0021

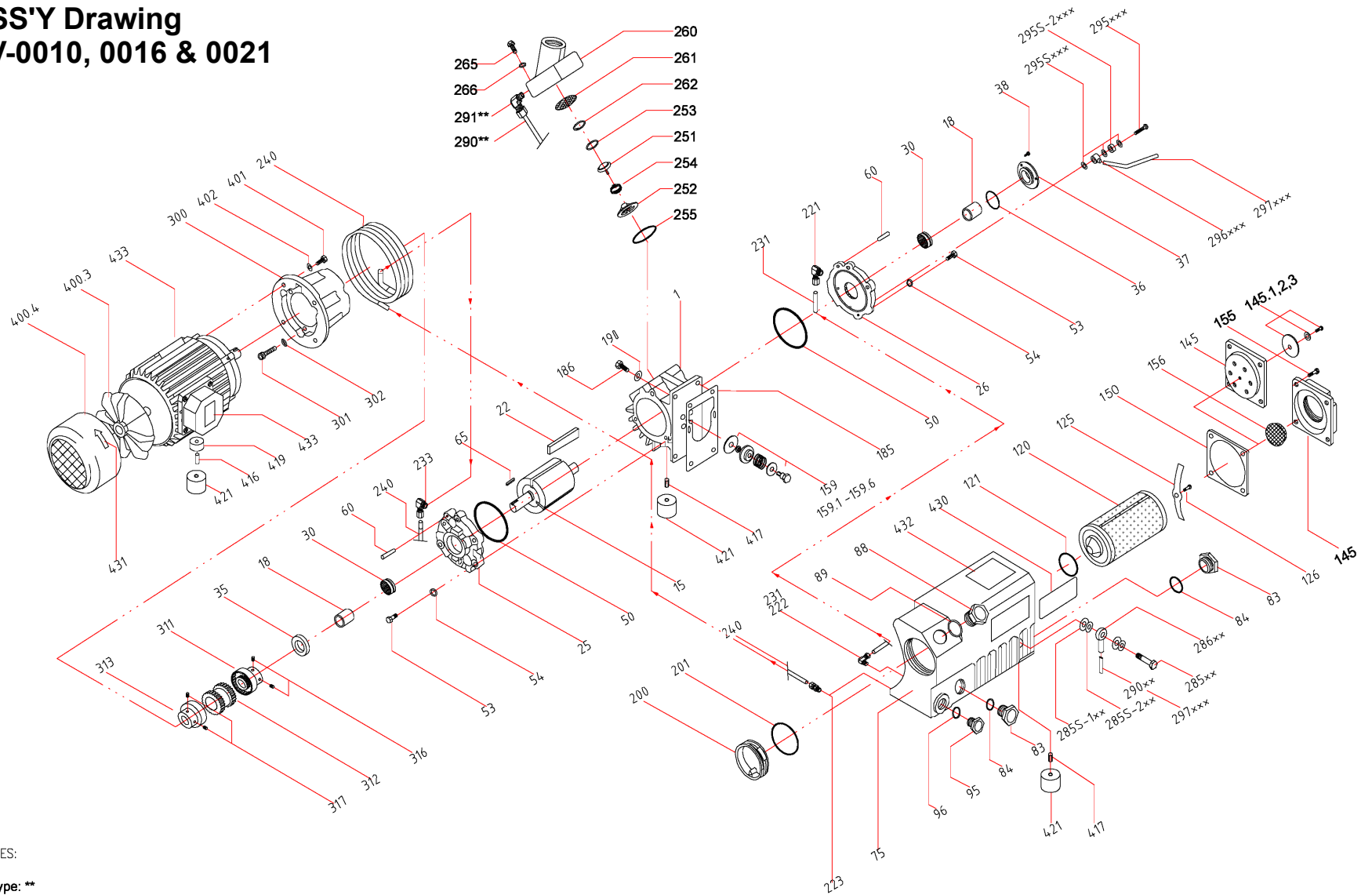

NOTES:  
L Type: \*\*  
NM Type: \*\*\*

**Eurovacuum B.V. EV-0016L & NM Spare Parts SN from 0601xxxx**

Pos No	QTY	SK	GK	OK	Description	Part Description	Art. No.
		↓			Service kit	See all parts marked at SK	002049900
			↓		Gasket Kit	See all parts marked at GK	002049000
				↓	Overhaul Kit	See all parts marked at OK	003050000
1	1				Cylinder	Cylinder	003000100
15	1				Rotor	Rotor	003001500
18	2			2	Sleeve, Bearing	IR Ø15xØ20x23	002001800
22	3			3	Vane	70x17.8x3.8	003002200
25	1				A-end plate	ID20.5/PCD90X3-Ø7	002002500
26	1				B-end plate	ID20.5/PCD90x3-Ø7	002002600
30	2			2	Bearing	Bearing	0000G0100
35	1		1	1	shaft seal	Ø20xØ32x6.5	0000USA00
36	1		1	1	O-Ring, Bracket	Ø24x3.5	0000U0500
37	1				Bracket	Ø31.5xØ60x12	002003700
38	3				Hexagon head screw	M5x12	0000A5D00
50	2		2	2	O-Ring, End plate	Ø70x2.5	0000U1300
53	6				Hexagon head screw	M6x25	0000A6G00
54	6				Spring lock washer	S/W, Ø6	0000F2D00
60	4			4	Taper pin	Ø4x25	00002H000
65	1				Shaft key	5x5x15	00008DE00
75	1				Oil sump	EV-0010 till 0021	002007500
83	1				Oil sight glass	G 3/4"	0000OSF00
84	1		1	1	Gasket, Oil sight glass	Ø26xØ32x1t	0000UTA00
88	1				Plug, Oil fill	G 3/4", 1/8" tap for gauge	0000OTFA0
88	1				Plug, Oil fill	G 3/4", Plastic type	0000OTF00
89	1	1	1	1	O-Ring, Oil drain plug	Ø22x2.0	0000U0400
90	1				Pressure gauge	0-1 Bar	00GA09000
95	1				Plug, Oil drain	G 1/2"	0000OTE00
96	1	1	1	1	O-Ring, Oil drain plug	Ø15x2.3	0000U0300
120	1	1		1	Exhaust filter	Ø35xØ70x130	002012000
121	1	1	1	1	O-Ring, Exhaust filter	Ø35x4.0	0000U0800
125	1				Exh. Filter spring Assembly	106x12x1.5t	002012500
126	1				Slotted cheese head machine screw	M4x25	0000E3F00
145	1				Exhaust cover (w/ rubber flap)	88x88/4-Ø6.5, 6-Ø9, Aluminum	002014500
145	1				Exhaust cover (threaded)	88x88/ 4-Ø6.5, 1-1/4" G	006014500
150	1	1	1	1	Gasket, Exhaust cover	87x87/Ø71/1t	002015000
155	4				Allen bolt	M6x20	0000B6F00
156	1				Outlet screen	Ø65x1t	006015600
159	1				Exhaust valve ass'y( 159.1~ 159.6)	Ø35xH20/M6	002015900
159-1	1				Exhaust valve fixed bolt	Ø8xM6x28	002015901
159-2	1				Exhaust valve washer	Ø8.5xØ25x1.6t	002015902
159-3	1				Exhaust valve spring	D20xNf4xL15xd0.75	002015903
159-4	1				Exhaust valve plate	Ø35x8x10t	002015904
159-5	1				Exhaust valve lock nut	Ø8xØ14x3.8t/M6	002015905
159-6	1		1	1	Exhaust valve seat plate	Ø8xØ36x2t	002015906
185	1		1	1	Gasket, Cylinder	130x72x1t	002018500
186	4				Allen bolt	M8x20	0000B8F00
190	4				Spring Lock Washer	S/W, Ø8	0000F2E00
200	1				Plug, Drum	R 2"	002020000
201	1		1	1	O-Ring, Drum plug	Ø55x3.0	0000U1000
221	1				Elbow hydraulic fitting	BLM 1/8"xØ4	00HF00200
222	1				Elbow hydraulic fitting	BLM 1/8"xØ4	00HF00200
223	1				Straight hydraulic fitting	BMC 1/8"xØ6 (B.S)	00HF01000
231	1				Oil tube(B)	Ø4x212	002023100
233	1				Elbow hydraulic fitting	BLS 1/8"xØ6 (B.S)	00HF00700
240	1				Cooling spiral	Ø128x42	002024000
251	1				Check valve plate	Ø4.5/Ø32x23.5 plastic	002025100
252	1				Check valve guide	Ø4.5/Ø46x15	002025200
253	1		1	1	O-ring, for Nozzle assy	Ø24x2.0	0000U0600
254	1				Check valve spring	D21xNf5xL18xd0.5	002025400
255	1		1	1	O-Ring, Inlet part	Ø56x2.5	0000U1100
260	1				Inlet flange, NM type	G 1/2"	0020260A2
260	1				Inlet flange, L type	G 1/2", G1/8" side	0020260A1
261	1			1	Inlet screen	Ø23	002026100
262	1				Retaining ring for bores	Ø26x1t	000016000
265	4				Hexagon head screw	M6x25	0000A6G00
266	4				Spring lock washer	S/W, Ø6	0000F2D00
270*	1				Plug (For N Only)	G1/8"	0000OTB00
275*	1				Oil return valve (For N Only)	M8x1.0x30	002027500
285**/****	1				Oil Recirculation Screw(For L /NM)	M8x1.0x40	002028500
285S-1*/**/****	1				Sealing ring for 275*/285**	Ø8.5xØ14x1t	00HF10300
285S-2**/****	2				Sealing ring	Ø8.5xØ12x1t	00HF10200
286**/****	1				Banjo fitting (For L /NM)	Ø8.5xØ4	002028600
290**	1				Return oil tube (For L Only)	Ø4x350	002029000
291**	1				Elbow hydraulic fitting (For L only)	BLM 1/8"xØ4	00HF00200
295***	1				Oil Return Valve (For NM Only)	Oil Return Valve (For NM Only)	002029500
296***	1				Banjo fitting (For NM Only) in end plate	Banjo fitting (For NM Only) in end plate	002029600
297***	1				Oil Return Tube (For NM Only)	Oil Return Tube (For NM Only)	002029700
300	1				Motor mounting bracket (IEC)	IEC, Fr 71, PCD 76/4-Ø7	002030000
301	3				Allen bolt	M6x70	0000B6P00
302	3				Spring lock washer	S/W, M6	0000F2D00
310A	1				Coupling Set (311 ~313)	for EV-0016; 3 phase motor	0030310A0
311A	1				Coupling, pump side	Sure Flex Type, Ø55xØ15	0040SCP00
312A	1	1		1	Coupling Sleeve	Rubber, Sleeve, Ø55x13t	0040SCI00
313A	1				Coupling, Motor side	Sure Flex Type, Ø55xØ14	0040SCM00
316	2				Set screw ( Motor side)	M8x10	0000C8C00
317	2				Set screw ( Motor side)	M8x10	0000C8C00
400	1				Motor (IEC)	Motor for EV-0016, 0.75kW, 3ph, 400V, 50Hz 4P	M31401700
400.3	1				Motor fan blade	Motor fan blade	003040003
400.4	1				Motor fan cover	Motor fan cover	003040004

Pos No	QTY	SK	GK	OK	Description	Part Description	Art. No.
		↓			Service kit	See all parts marked at SK	002049900
			↓		Gasket Kit	See all parts marked at GK	002049000
				↓	Overhaul Kit	See all parts marked at OK	003050000
401	4				Hexagon head screw	M6x25	0000A6G00
402	4				Spring lock washer	S/W, Ø6	0000F2D00
416	1				Slotted set screw	M8x30	0000C8H00
417	2				Slotted set screw	M8x20	0000C8F00
419	1				Sleeve	Ø9xØ25x10t	002041900
421	3				Rubber foot	Ø30x20/M8	0000F8E00
510	1				Conversion kit, L type	20 mbar ((including # 02260-2)	003051000
530	1				Conversion kit, NM Type	2 mbar	003053000
550	1				Inlet Check Valve Kit (251 ~266)	Inlet Check Valve Kit (251 ~266)	002055000
900	1				Pump Module	Pump module	003090000